



VISITING TEAM GUIDE



**Department of Athletics and Recreation
EVENT MANAGEMENT**



Dear Coach,

On the behalf of the Athletics & Recreation Department at Bridgewater State University, the Events Management Staff would like to welcome you to our campus. While we realize that travel in New England can be very hectic at times, there are things that can happen on game day that are beyond our control. However, as part of our Hospitality Program we hope that the following information will make your travel and arrival to BSU as worry free as possible. Enclosed you will find directions to our athletic facility, a campus map and a list contact phone numbers. Also attached is a list of phone numbers and locations of local eateries.

We look forward to your visit and good luck with your season!

Following sports should follow directions to Kelly Gymnasium:

GPS Address: 34 Park Avenue, Bridgewater, MA

Football

Wrestling

Men's and Women's Swimming and Diving

- Visiting Football teams will use the locker facilities at the Kelly Gym and travel to Swenson Field for the game. A member of the Home Events Staff will meet and accompany the team to Swenson Field.

Following sports should follow directions to Tinsley Center:

GPS Address: 325 Plymouth Street, Bridgewater, MA

Men's and Women's Soccer

Field Hockey

Volleyball

Men's and Women's Basketball

Women's Lacrosse

- Upon arrival teams should be dropped at the front door. Busses and vans can then proceed to back of the building where ample bus and van parking is available.
- Upon entering the Tinsley Center you will be met by a member of the Home Events Staff who will show you to your locker room. You will be given a key which must be returned prior to your departure.

Baseball and Softball teams should follow directions to Tinsley Center **BUT** drop off teams at entrance to baseball and softball complex in the Swenson Field lot.

GPS Address: 325 Plymouth Street, Bridgewater, MA

Detailed Directions to campus at the end of guide.

Following sports should follow directions to Tinsley Center, with the addition

GPS Address: 325 Plymouth Street, Bridgewater, MA

Men's and Women's Tennis

- Upon arrival teams should be dropped at the front door. Busses and vans can then proceed to back of the building where ample bus and van parking is available.
- Upon entering the Tinsley Center you will be met by a member of the Home Events Staff who will show you to your locker room. You will be given a key which must be returned prior to your departure.

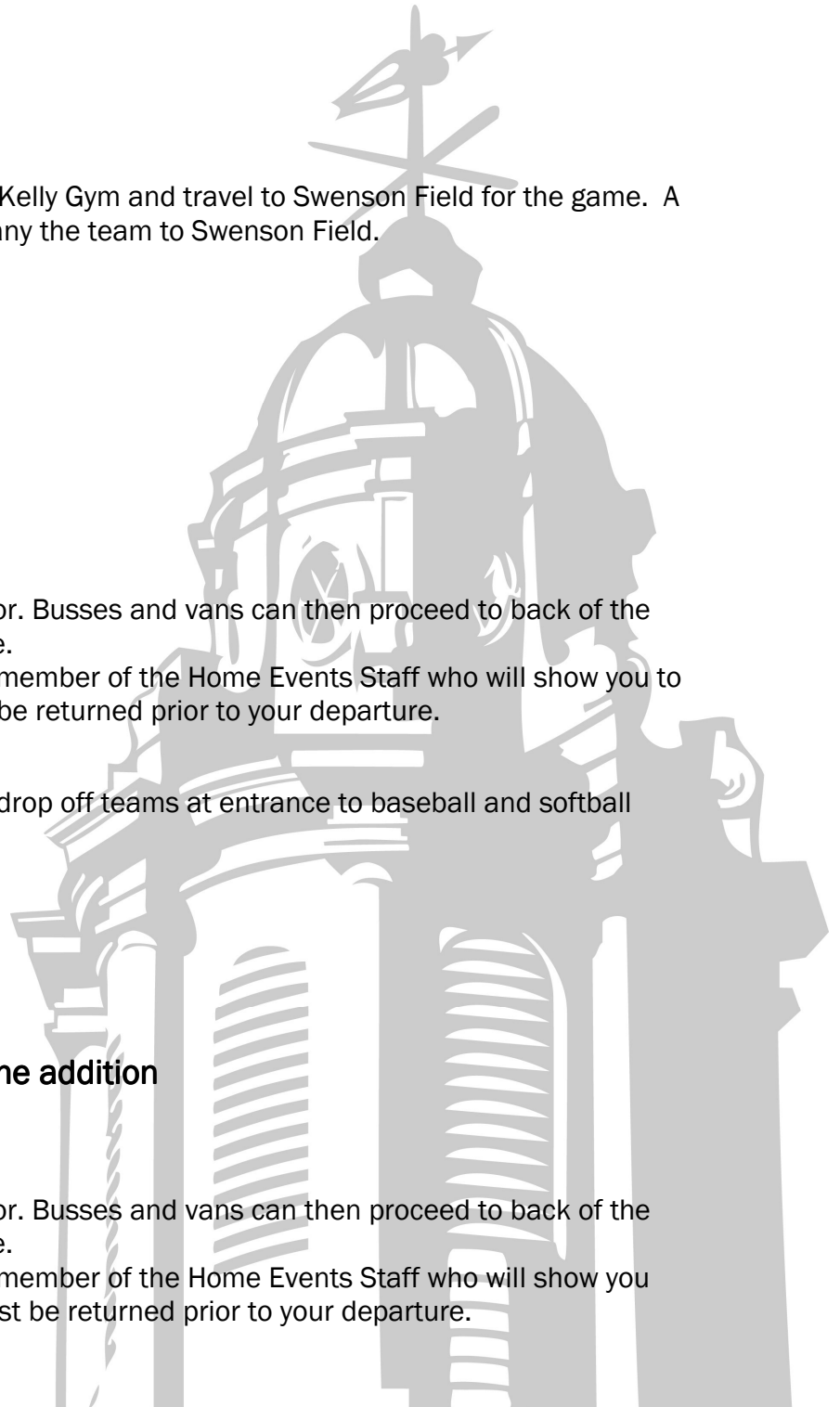



Locker Room / Post Game Accommodations

All visiting teams will be issued a locker room upon arrival unless one is not available. If you require a locker room or space for a post– game meal please contact Mike Donovan (508) 531-2385 in advance.

Athletic Training / Sport Medicine Center

The Athletic Training room is available to visiting teams pre & post game. The Athletics Training / Sports Medicine Center s are located at The Tinsley Center 108 and the Basement level of Kelly Gymnasium.

EQUIPMENT AND SUPPLIES: We will provide ice, water, cups or water bottles, crutches, splints and radio communication at each field or court for all com petitions. We cannot provide tape and wraps but will be glad to help your athletes if they bring their own supplies.

MODALITIES: All Certified Athletic Trainers may use any of our modalities, which include the following: ice, heat packs, cold packs, ultrasound, and electrical stimulation. If your team is traveling with an athletic training student or without medical personnel, please send a written note for use of any of the electrical modalities other than ice.

PRE-GAME PREPARATION: A Certified Athletic Trainer will be available from approximately two hours prior to an event to thirty minutes after the conclusion of an event. If your team needs any special care, please contact us in advance.

COVERAGE: A Certified Athletic Trainer will be on-site for all home contests. Athletic training students in our educational program will also be at each game. At times, due to multiple contests at one time, a Certified Athletic Trainer may need to be covering two adjacent events simultaneously. We apologize for any inconvenience this may cause but will assure you that the highest risk sports will take priority.



Jeanne O'Brien, MS. LATC Head Athletic Trainer: (508) 531-1765

Steve Glazier, LATC, CSCS Assistant Athletic Trainer: (508) 531-2549

Joseph Mosher, Med. LATC, CSCS Assistant Athletic Trainer: (508) 531-2343

Melissa Ryan, LATC Assistant Athletic Trainer (508) 531-2319

Tinsley Athletic Training facility: (508) 531-2044

Kelly Athletic Training facility: (508)531-2859

For EMS call: (508)531-1212 or 911

HOSPITAL: Good Samaritan Medical Center, 235 North Pearl Street, Brockton, MA (508) 427-3233

BSC Athletics Office

508-531-1352 fax 508-531-1356

Event Manager

Mike Donovan

508-531-2385 cell 508-274-2720

Director of Athletics

John Harper

508-531-1352

Associate Director of Athletics - Intercollegiate Sports

Mike Storey

508-531-2350

Associate Director of Athletics - SWA/Compliance

Sue Crosby-Tangen

508-531-2280

Associate Director of Athletics - Operations

Glenn Gonsalves

508-531-2281 cell 774-826-6547

Sports Information

Mike Holbrook

508-531-2656

Equipment Room – Tinsley Center

508-531-2145

Equipment Room – Kelly Gym

508-531-2980

Tinsley Center Front Desk

508-531-2970

Moriarty Pool – Kelly Gym

508-531-2062

Swenson Field – Press Box

508-531-2563

Campus Police

508-531-1212

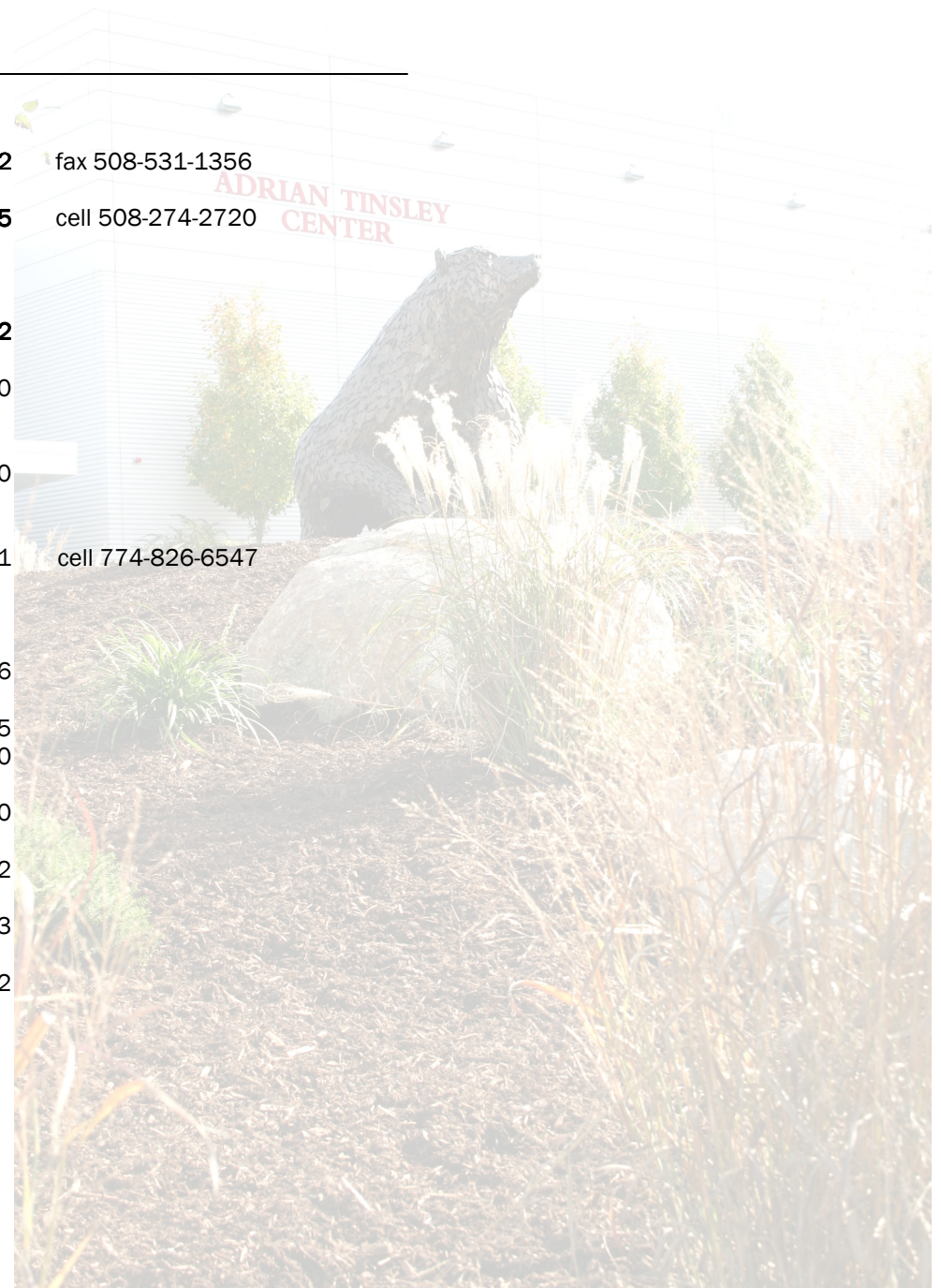



HOTEL SUGGESTIONS



Fairfield Inn Marriot and the Courtyard Marriot the “Preferred Destinations” of visiting teams to Bridgewater State College Athletics.

Contact Jennifer Halvorsen-Costa 508-946-4000

Ref. BSC Athletic Rate

4 Chalet Road (Rt. 44)

Middleboro, MA 02346

www.marriot.com/PYMFM



Courtyard by Marriott Raynham

37 Paramount Dr

Raynham, MA 02767

508-822-8383

Day's Inn
Plymouth/Middleboro
30 East Clark Street
Middleboro, MA 02346
508- 946-4400
Contact: Gisele Thomas

Residence Inn by Marriott (Easton/Brockton)
124 Liberty Street
Brockton, MA 02301
508-583-2001
Contact: Christine Richards

Holiday Inn Taunton
195 Westgate Drive
Brockton, MA 02301
508-588-6300

FOOD SUGGESTIONS

Tinsley Center - Bear Trap East Campus Commons

Dunkin Donuts
Book Store
ATM
Cafeteria

Directions: Take left out of Tinsley Center, follow pathway up the hill to the clock tower.

East Campus Commons will be directly in front of you

Mon-Fri: 7 AM – 7:30PM

Sat-Sun: 9 AM – 7PM

Crimson Hall Food Court

Grill
Stir-fry
Pasta/Pizza Bar
Ice Ream / Smoothies

OFF-CAMPUS

Campus Plaza

99 Restaurant & Pub	(508) 279-2799
Subway	(508) 697-0600
Papa Gino's	(508) 697-8137
McDonald's	(508) 697-9568
Dunkin Donuts	(508) 697-6295
KFC / Taco Bell	(508) 697-8436
Burger King	(508) 279-9711
Roche Bros. Supermarket/Deli	(508) 697-5077
Bank of America ATM	

Bridgewater House of Pizza	(508) 697-4862
Lorenzo's Pizzeria	(508) 697-1104
D'Angelos Sub Shop	(508) 697-5500

Directions from Tinsley Center: Take left at the end of Tinsley Drive onto Plymouth Street (Rte. 104)

Take right at first set of lights onto Spring Street Campus Plaza is on the right at the end of Spring Street

These establishments will deliver to Tinsley Center, give x2970 as number for order.

Team Travel Meal Option



Broad Street ~ Bridgewater, MA
508 – 697 – 5500
Ask for Debbie

Coaches,

D'Angelo's on Broad Street in Bridgewater has offered a travel meal deal for your team. Each player can order any sandwich, and any size which includes chips and a fountain drink for \$9.00. This deal includes free sandwiches for each coach and the bus driver.

Orders must be filled out on the special order form and dropped off or Faxed to the store 24 hours in advance of the trip.

Order needs a contact person's name and cell phone.

Supply the time of pick up, and travel date.

Although the players can choose anything on the menu, try to keep the orders simple.

Please make sure you make a copy of your order form for yourself.

Please write legibly on the form, they will write the players last name on the sandwich.

For Pdf copy of order form go to www.bsubears.com/insideathletics

ORDER FORM



Team: _____
 Contact: _____
 Cell: _____

Pick up date: _____
 Pick up time: _____



1	Last Name						Size						Meat	Fillers					Condiments					Salad Dressing	Beverage	chips
	S	M	L	Poc	Wrp		Let	Tom	Pick	Onion	Hots	Ket		Must	Mayo	Oil	H.Must									
2																										
3																										
4																										
5																										
6																										
7																										
8																										
9																										
10																										
11																										
12																										
13																										
14																										
15																										
16																										
	Last Name						Size						Meat	Fillers					Condiments					Salad Dressing	Beverage	chips
	S	M	L	Poc	Wrp		Let	Tom	Pick	Onion	Hots	Ket		Must	Mayo	Oil	H.Must									

Team Travel Meal Option



233 Broad Street ~ Bridgewater, MA

508-697-0600

508-245-9305 cell

eatfreshorder@gmail.com

Ask for CK

Coaches,

Subway in Campus Plaza on Broad Street in Bridgewater has offered a travel meal deal for your team. Each player can order a foot long sandwich, chips and a fountain drink for \$8.50.

Order needs a contact person's name and cell phone.

Supply the time of pick up, and travel date.

Although the players can choose anything on the menu, try to keep the orders simple.

Please make sure you make a copy of your order form for yourself.

Please write legibly on the form, they will write the players last name on the sandwich.

Directions to the Campus Venues

Directions from Boston:

- Take I-93 South to Route 24 South
- Follow Route 24 South to Exit 15 (Bridgewater/Raynham – Route 104 East)
- Take Route 104 East to stop sign (approximately 3 miles)
- Turn left and approach rotary in Bridgewater Center
- Proceed to rotary; stay in right lane within rotary
- Just before traffic light, bear right in front of the Shell gas station onto Summer Street (Route 104 East)
- Bear left through traffic light (Mobil station on left)
- Go over railroad tracks
- Stay on Route 104 East for approximately $\frac{3}{4}$ mile take a right onto Tinsley Drive (After turn, the Tinsley Center will be at the end of Tinsley Drive and the Athletic Fields will be on your left)

Directions from Other Points North:

- Take I-95 South to 495 South
- Take Exit 7A (Route 24 North)
- Follow Route 24 North to Exit 15 (Bridgewater/Raynham – Route 104 East)
- Take Route 104 East to stop sign (approximately 3 miles)
- Turn left and approach rotary in Bridgewater Center
- Proceed to rotary; stay in right lane within rotary
- Just before traffic light, bear right in front of the Shell gas station onto Summer Street (Route 104 East)
- Bear left through traffic light (Mobil station on left)
- Go over railroad tracks
- Stay on Route 104 East for approximately $\frac{3}{4}$ mile take a right onto Tinsley Drive (After turn, the Tinsley Center will be at the end of Tinsley Drive and the Athletic Fields will be on your left)

Directions from Providence, RI and Points South:

- Follow I-95 North to I-495 South to Exit 7A (Route 24 North)
- Once on Route 24 North, take exit 15 (first exit, Bridgewater/Raynham - Route 104 East)
- Take Route 104 East to stop sign (approximately 3 miles)
- Turn left and approach rotary in Bridgewater Center
- Proceed to rotary; stay in right lane within rotary
- Just before traffic light, bear right in front of the Shell gas station onto Summer Street (Route 104 East)
- Bear left through traffic light (Mobil station on left) onto Plymouth Street
- Go over railroad tracks
- Stay on Route 104 East for approximately $\frac{3}{4}$ mile

Take a right onto Tinsley Drive (After turn, the Tinsley Center will be at the end of Tinsley Drive and the Athletic Fields will be on your left)

Directions from the West:

- Follow the Massachusetts Turnpike (I-90) to I-495 South to Exit 7A (Route 24 North)
- Once on Route 24 North, take Exit 15 (first exit, Bridgewater/Raynham - Route 104 East)
- Take Route 104 East to stop sign (approximately 3 miles)
- Turn left and approach rotary in Bridgewater Center
- Proceed to rotary; stay in right lane within rotary
- Just before traffic light, bear right in front of the Shell gas station onto Summer Street (Route 104 East)
- Bear left through traffic light (Mobil station on left) onto Plymouth Street
- Go over railroad tracks
- Stay on Route 104 East for approximately $\frac{3}{4}$ mile

Take a right onto Tinsley Drive (After turn, the Tinsley Center will be at the end of Tinsley Drive and the Athletic Fields will be on your left)

Directions from the East:

- Follow Route 106 West to Route 104 West
- Take a left onto Tinsley Drive (After turn, the Tinsley Center will be at the end of Tinsley Drive and the Athletic Fields will be on your left)

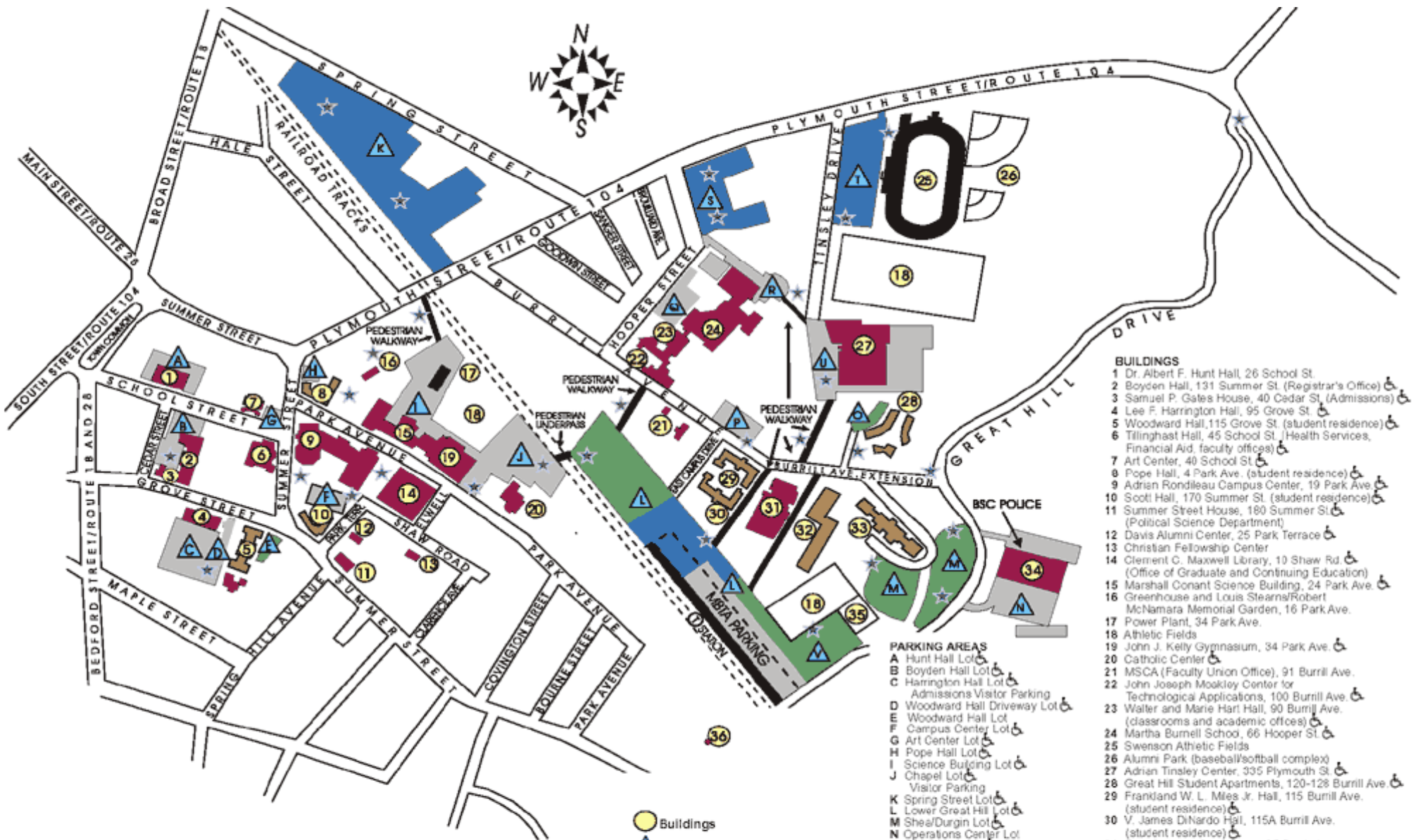

CAMPUS MAP

BRIDGEWATER STATE

- Buildings
- ▲ Parking Lots
- Resident Parking
- Commuter Parking
- Staff/Faculty Parking
- Administrative Buildings
- Residence Halls
- ★ Blue Light Phones for Emergencies

- PARKING AREAS**
- A Hunt Hall Lot
 - B Boyden Hall Lot
 - C Harrington Hall Lot
 - D Woodward Hall Driveway Lot
 - E Woodward Hall Lot
 - F Campus Center Lot
 - G Art Center Lot
 - H Pope Hall Lot
 - I Science Building Lot
 - J Chapel Lot
 - K Spring Street Lot
 - L Lower Great Hill Lot
 - M Shea/Durgin Lot
 - N Operations Center Lot
 - O Apartments Lot
 - P Mookley Center Lot
 - Q Burrill School Lot
 - R Children's Center Lot
 - S Hooper Street Lot
 - T Swenson Field Lot
 - U Tinsley Center Lot
 - V Rosen Lot
- Handicapped Parking**
- Handicapped Accessible**

- BUILDINGS**
- 1 Dr. Albert F. Hunt Hall, 26 School St.
 - 2 Boyden Hall, 131 Summer St. (Registrar's Office)
 - 3 Samuel P. Gates House, 40 Cedar St. (Admissions)
 - 4 Lee F. Harrington Hall, 95 Grove St.
 - 5 Woodward Hall, 115 Grove St. (student residence)
 - 6 Tillinghast Hall, 45 School St. (Health Services, Financial Aid, faculty offices)
 - 7 Art Center, 40 School St.
 - 8 Pope Hall, 4 Park Ave. (student residence)
 - 9 Adrian Rondileau Campus Center, 19 Park Ave.
 - 10 Scott Hall, 170 Summer St. (student residence)
 - 11 Summer Street House, 180 Summer St. (Political Science Department)
 - 12 Davis Alumni Center, 25 Park Terrace
 - 13 Christian Fellowship Center
 - 14 Clement C. Maxwell Library, 10 Shaw Rd. (Office of Graduate and Continuing Education)
 - 15 Marshall Conant Science Building, 24 Park Ave.
 - 16 Greenhouse and Louis Stearns/Robert McNamara Memorial Garden, 16 Park Ave.
 - 17 Power Plant, 34 Park Ave.
 - 18 Athletic Fields
 - 19 John J. Kelly Gymnasium, 34 Park Ave.
 - 20 Catholic Center
 - 21 MSCA (Faculty Union Office), 91 Burrill Ave.
 - 22 John Joseph Mookley Center for Technological Applications, 100 Burrill Ave.
 - 23 Walter and Marie Hart Hall, 90 Burrill Ave. (classrooms and academic offices)
 - 24 Martha Bumell School, 66 Hooper St.
 - 25 Swenson Athletic Fields
 - 26 Alumni Park (baseball/softball complex)
 - 27 Adrian Tinsley Center, 335 Plymouth St.
 - 28 Great Hill Student Apartments, 120-128 Burrill Ave.
 - 29 Frankland W. L. Miles Jr. Hall, 115 Burrill Ave. (student residence)
 - 30 V. James DiNardo Hall, 115A Burrill Ave. (student residence)
 - 31 East Campus Commons, 125 Burrill Ave. (bookstore)
 - 32 East Hall, 135 Burrill Ave. (student residence)
 - 33 Shea Hall and Durgin Hall, 160 Burrill Ave. (student residences)
 - 34 Campus Police Headquarters, 200 Great Hill Drive
 - 35 Operations Center, 200 Great Hill Drive
 - 36 Dr. Henry Rosen Memorial Tennis Courts
 - 37 Astronomy Observatory, 400 Summer St.